

## CFX PUMP REPLACEMENT

Tools Required: Phillips screwdriver, needle nose pliers, 5/16" wrench or nut driver, 7/16" wrench, Crescent wrench, Teflon tape, lock-tight adhesive.

### PUMP REMOVAL

- 1) Remove the two cover plate screws and unplug the cover plate from the wire harness.



- 2) Remove the exhaust manifold screw and remove the exhaust manifold.



- 3) Unlatch the CFX top housing from the bottom housing and turn it upside down, placing the top inside the bottom housing.



- 4) Use a 5/16" wrench or nut driver to remove the eight deck plate screws

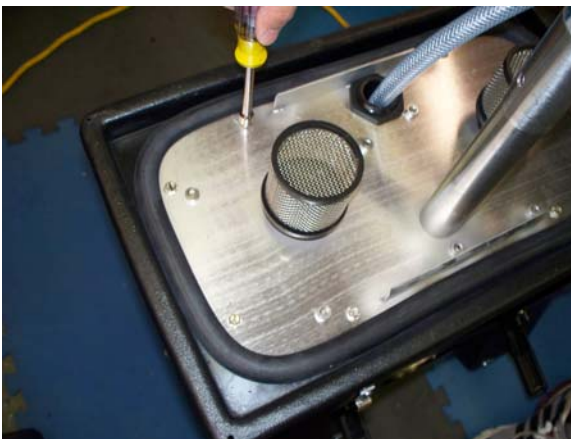

- 5) Holding the deck plate firmly to the top housing, turn the top housing over and place it back on top of the bottom housing.



6) Lift up on the top housing, removing it from the deck plate.



7) Use a pair of needle nose pliers to unplug the wires from the pump to the wire bundle.

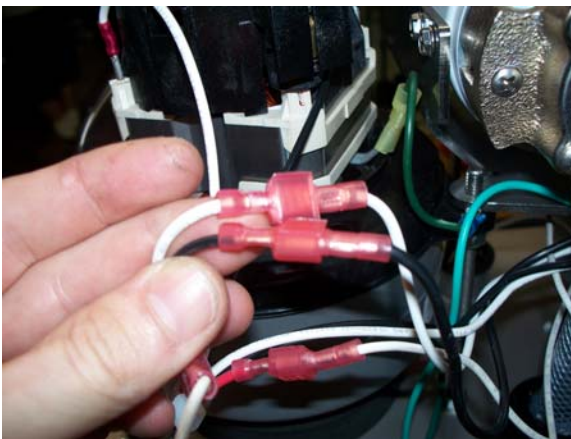

8) Use a Crescent wrench to remove the hose fitting from the bottom of the pump.

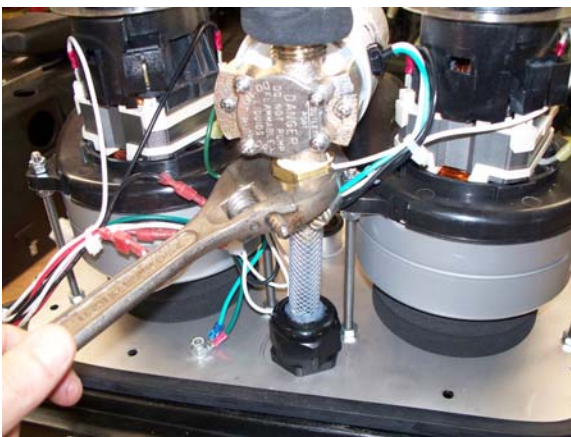

- 9) Use a 7/16" wrench to remove the three pump mounting nuts and remove the pump.

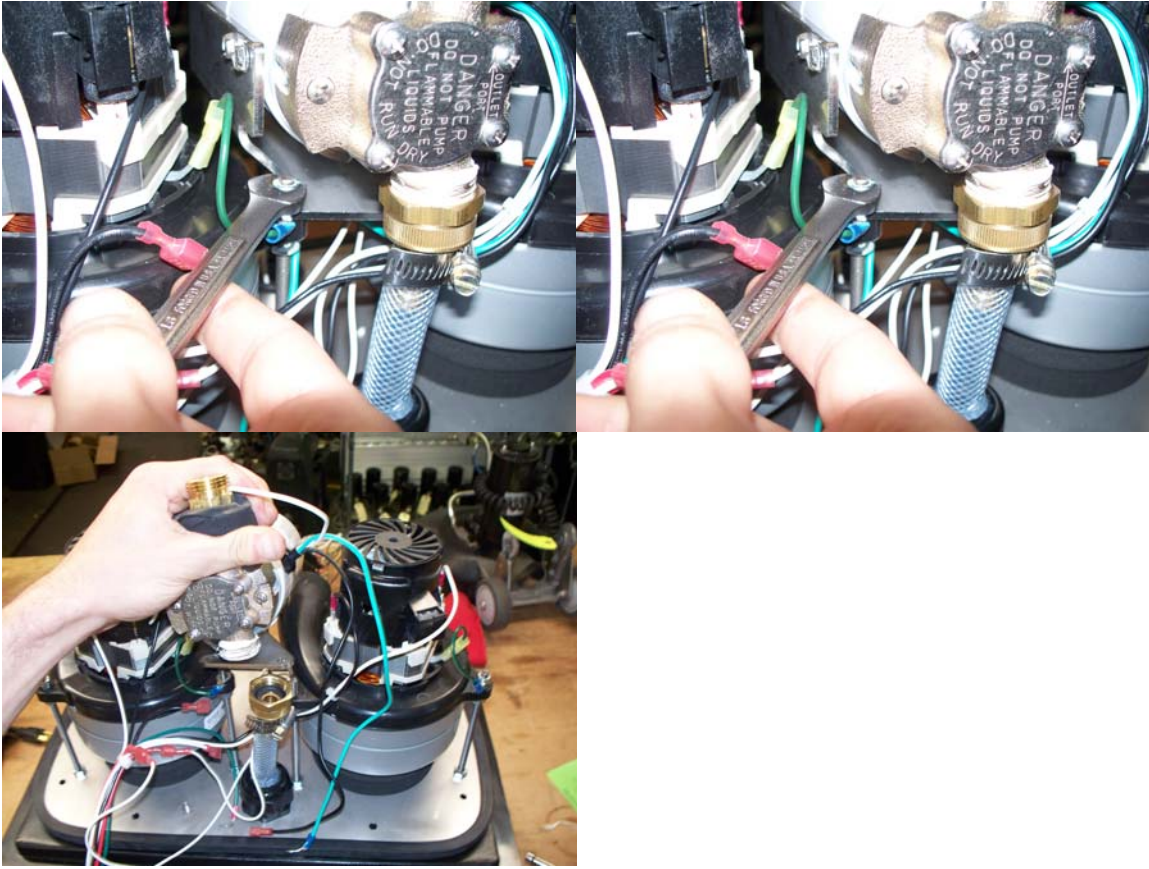

## PUMP INSTALLATION

- 1) Place the pump assembly onto the CFX so that the bottom of the pump lines up with the suction hose.
- 2) Line the bottom of the pump with Teflon tape and use a crescent wrench to fasten the suction hose to the pump.
- 3) Use a 7/16" wrench to install the three pump mount nuts. Note: Over tightening of the pump mount nuts can result in breaking the housing of the vacuum motors.
- 4) Plug in the two pump wires and use a 7/16" wrench to fasten the ground wire.
- 5) Zip tie the wire bundle neatly into place.
- 6) Place the upper housing on the deck plate assembly, then turn it over place the top inside the bottom housing
- 7) Use a 5/16" socket or nut driver to install the eight deck plate screws.
- 8) Replace the control plate and exhaust manifold.